

Pg 25

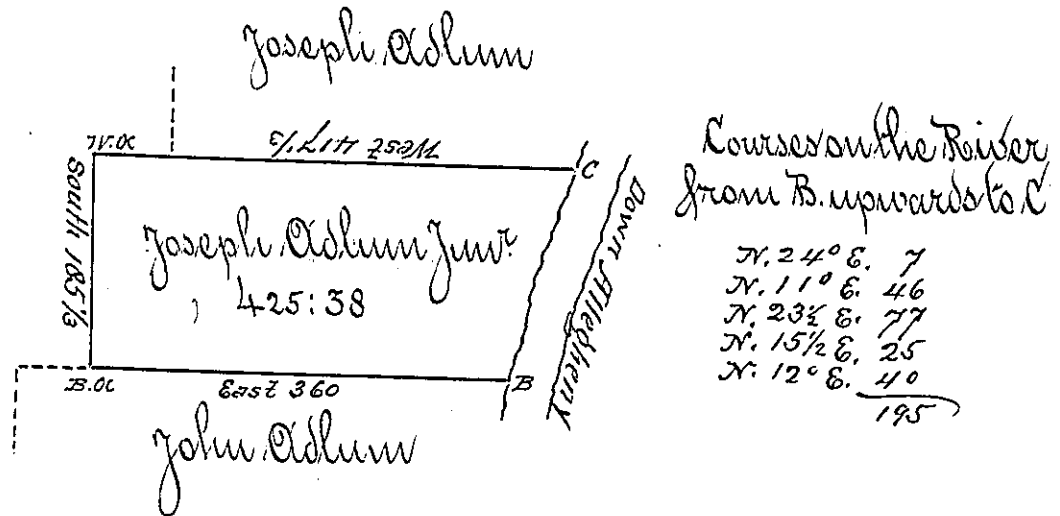

Courses on the Border from B. upwards to C

N. 24° E.	7
N. 11° E.	46
N. 23 1/2° E.	77
N. 15 1/2° E.	25
N. 12° E.	40
	<hr/> 195

Pg 32

Surveyed on the 24th day of June 1795 the above described Tract of Land in District 906
 in pursuance of a Warrant to Joseph Adlum Junr. dated 20th December 1793. Containing
 four Hundred Twenty five acres & thirty eight perches and allowance of six per Cent
 To Daniel Brodhead Esq. }
 Surveyor General }
 Daniel Nicholson
 D.S.

IN TESTIMONY that the above is a copy of the original remaining on file in
 the Department of Internal Affairs of Pennsylvania, made
 conformably to an Act of Assembly approved the 16th day of
 February, 1833, I have hereunto set my Hand and caused
 the Seal of said Department to be affixed at Harrisburg,
 this second day of September 1902.

James W. Linn
 Secretary of Internal Affairs.